

Coway

We Bring Wellness

APM-1010DH
AIR PURIFIER

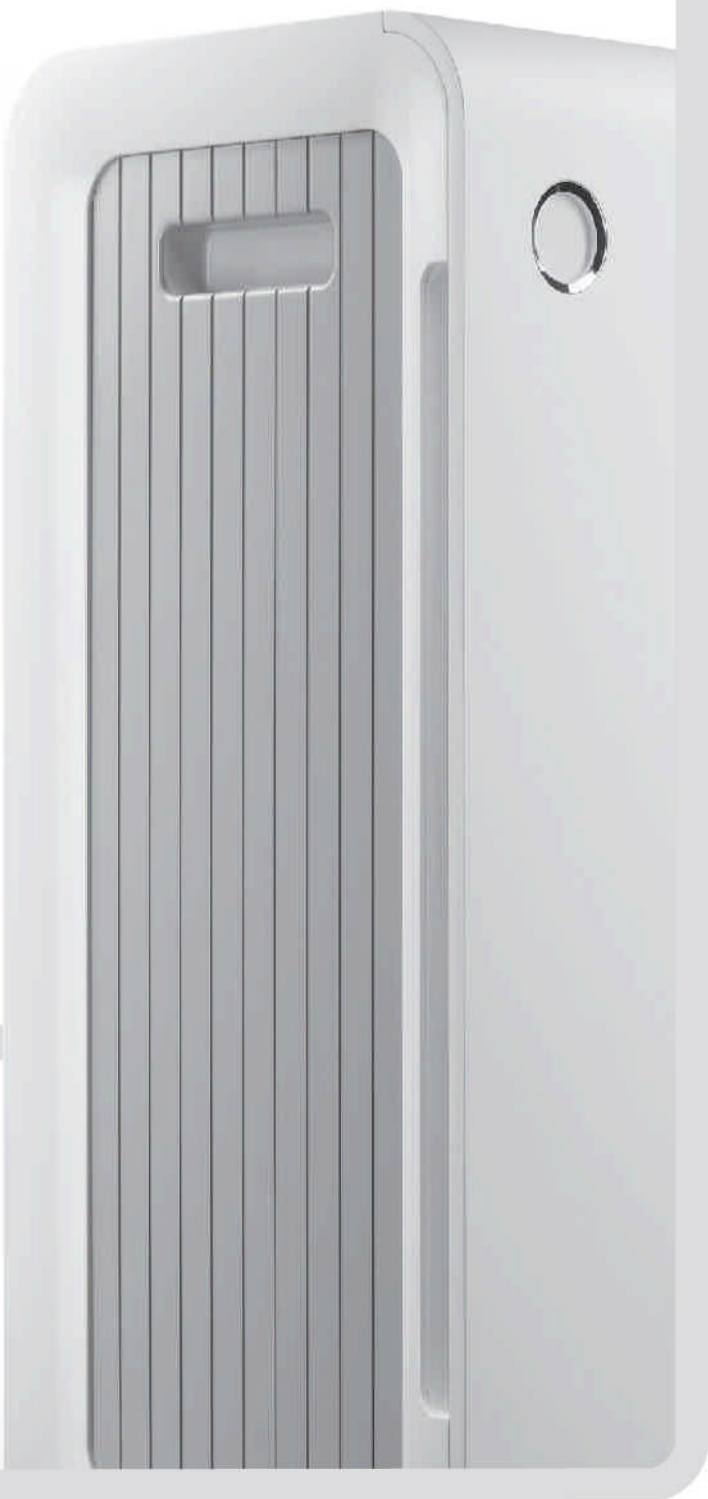

Before operating the unit, please read this manual thoroughly,
and retain it for future reference.

**Owner's
Instructions**



FEATURES



An innovative ANTI-FLU HEPA™ filter system

Coway's innovative ANTI-FLU HEPA™ captures micro particles and inactivates viruses up to 99.9 %. The filter system has been optimized to quickly remove pollutants from the air.

- This appliance is not a medical device.



Air purification & humidification combo system

This product provides hybrid functions where the air purification function removes fine dust, viruses, and harmful gases, and the natural humidification function uses a humidification filter.



Optimized humidification system

Both a humidification filter and a humidity sensor have been adopted to control the amount of moisture supplied on the basis of the room temperature and the humidity condition.



Powerful & hygienic humidification performance

A vaporization-type humidification system has been adopted that supplies 450 ml or more moisture per hour.



Auto-off timer

You can select the timer (1hr, 4hr, and 8hr) so it automatically turns off when the desired time has elapsed.



Selectable custom filters

A customized filter system has been adopted so that customers can select one of 3 types of option filters: dust, new-house or old-house filters.



3-step automatic operation using the particle sensor

The pollution level of the air is represented in real-time through the particle sensor and the air flow speed is automatically controlled on the basis of the surrounding pollution level when the automatic operation is selected to minimize power consumption.

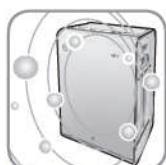

Air quality indicator





It shows the indoor air pollution level measured by the particle sensor. The color of air quality indicator changes in real-time according to the indoor air pollution level.



3-step hygiene humidification system

It consists of humidification, anti-scale and anti-bacterial filters and protects the water in the water tank and the tray from being contaminated.

CONTENTS

	FEATURES.....1		HOW TO USE.....9
	CONTENTS.....2		ADJUST PARTICLE SENSOR..... 11
	SAFETY INFORMATION.....2		FILLING UP THE WATER TANK..... 12
	PARTS NAME..... 4		CLEANING METHOD.....13
	Front/Top View 4		FILTER REPLACEMENT..... 18
	Indication part / Operation part..... 5		NATURAL VAPORIZATION
	AIR PURIFICATION PROCESS.....6		HUMIDIFICATION 20
	AIR HUMIDIFICATION PROCESS.....7		TROUBLESHOOTING21
	PREPARATIONS.....7		SPECIFICATIONS.....22

SAFETY INFORMATION

 **Danger : Failing to follow the precautions below may result in serious injury or even death.**

- Do not use a damaged power plug or loose electric outlet.
- Please connect the power plug to a dedicated grounded electrical outlet for 220 V - 240 V~ 50 Hz / 60 Hz.
- Do not move the product by pulling only the power cord.
- Do not handle the power plug with wet hands.
- Do not forcefully bend the power cord or place it under a heavy object to prevent it from being damaged or deformed.
- Do not repeatedly connect and disconnect the power plug.
- If the electric outlet is wet, carefully unplug the product and let the electric outlet dry completely before subsequent use.
- Make sure to unplug the product before repairing, inspecting or replacing a part.
- Remove any dust or water from the power plug.
- Do not plug the product into an electrical outlet or power strip that is being used by several other appliances. Use an electrical outlet dedicated to the product.
- Unplug the system if it is not used for a long time.
- Do not attempt to repair or modify the power cord yourself.
- If the power cord is damaged, do not replace the cord yourself. Call a service center to have it replaced.
- Do not install the product near a heating device.
- Do not install the product in locations exposed to moisture or water (rainwater).
- Do not use the product in areas where flammable gases or combustible materials are used or stored.
- Do not insert sharp objects such as a gimlet into the pollution sensor.
- If the product produces a strange noise, burning smell or smoke, unplug it from the electrical outlet immediately and call our service center.
- Never place the product in water.
- Do not spray any flammable materials such as insecticides or air fragrances near or into the air inlet.
- Do not disassemble, repair, or modify the product at your own discretion.
- Do not place any containers with water, medicine, food, metallic objects or flammable material on top of the product.

SAFETY INFORMATION

⚠ Danger : Failing to follow the precautions below may result in serious injury or even death.

- Unplug the system before cleaning it.
- Clean by spraying water directly and do not clean the product using benzene or thinner.
- Do not use the air purifier in a factory or industrial setting where machine oil may be present in the air.
- Do not eat the antibiotics in the water tray.
- Avoid external impacts to the water tank. A strong impact may damage the water tank.
- Empty the water tray and the water tank before moving the product.

⚠ Warning : Failing to follow the precautions below may result in considerable physical injury or property damage.

- Do not insert fingers or foreign objects into the air inlet or outlet.
- Do not let children hang on to the product or climb on it.
- When removing the front cover, exercise caution that a part of your body or any kind of object does not become stuck in the top part of the product.
- This appliance is not intended for use by persons (including children) with reduced physical, sensory or mental capabilities, or lack of experience and knowledge, unless they have been given supervision or instruction concerning use of the appliance by a person responsible for their safety.
- Children should be supervised to ensure that they do not play with the appliance.

⚠ Caution : Failing to follow the precautions below may result in slight physical injury or property damage.

- Do not install the product on a sloped surface.
- Do not apply force or impact to the product.
- When the product is in use, maintain a distance of at least 20 cm from the walls or adjacent objects and 30 to 60 cm above the product.
- Install the product so that no obstacles block the circulation of air around the product.
- Install the air purifier away from strong artificial lighting or direct sunlight.
- Install the air purifier at least 2 m away from electronic appliances such as a TV.
- Do not install the air purifier in a location exposed to direct sunlight.
- Replace the filters according to the filter replacement cycles.
- Clean the Pre-filter with water regularly and dry it completely before use.

PARTS NAME

Front / Top View

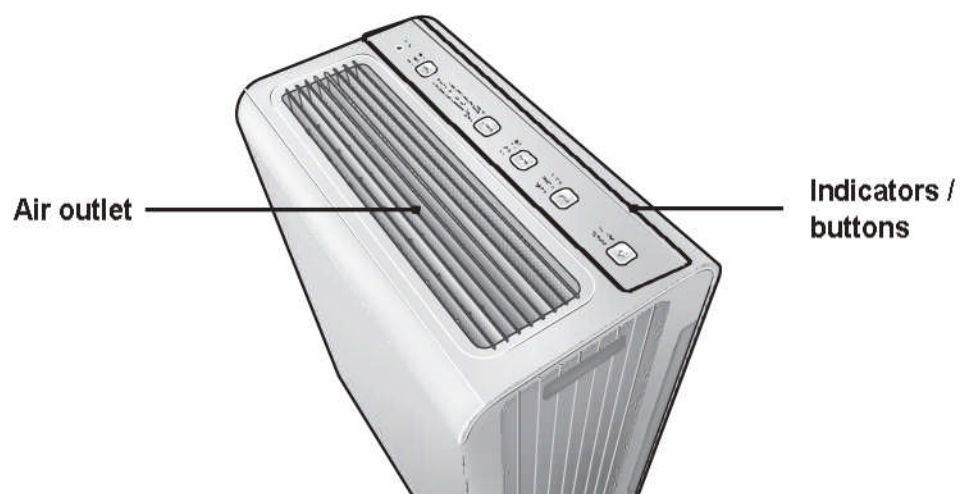
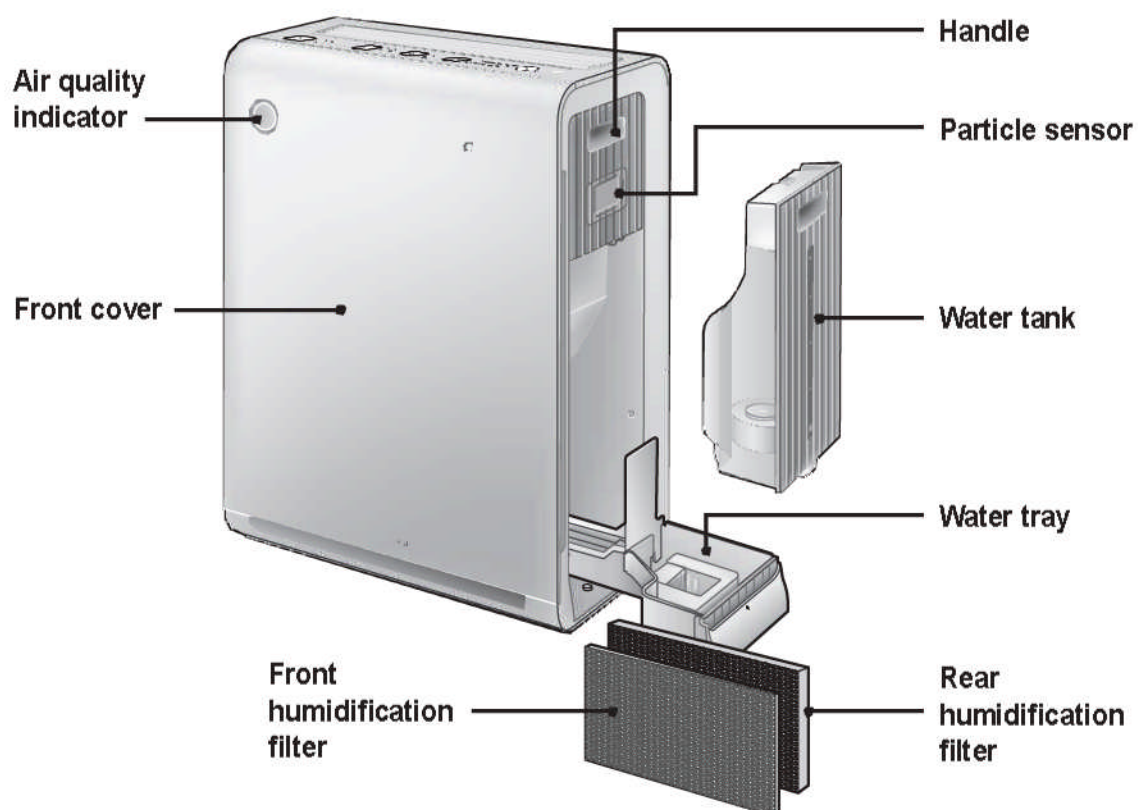

PARTS NAME

Indication part / Operation part

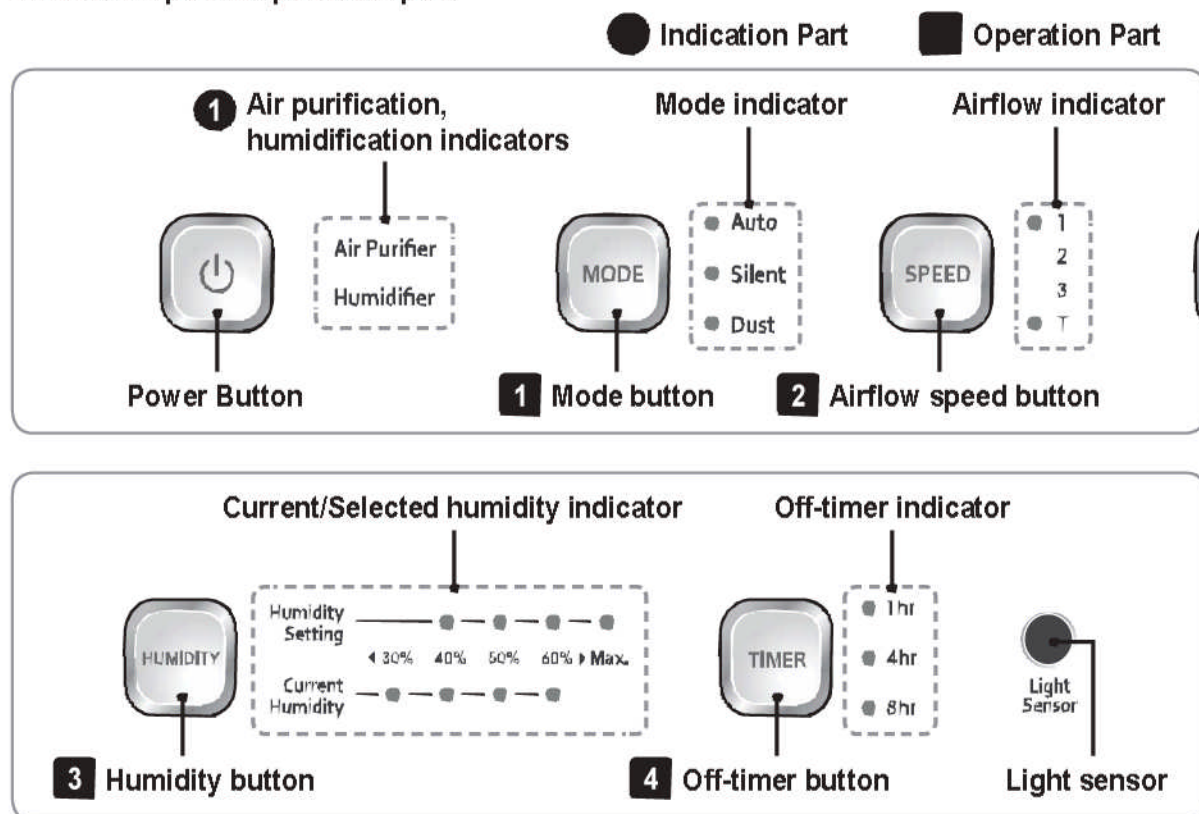

1 Air purification, humidification indicators

- When only the air purification indicator is on : Since the water tank is empty, only the air purification function is performed.
- When both the air purification and humidification indicators are on : The water tank is filled with water and both the humidification and air purification functions are performed.

* If the water tank is not installed or not properly installed, the operation mode indicator blinks.

1 Mode button

Using the mode button, you can select the operating mode in 3 steps in the following order: Auto → Silent → Dust

2 Airflow speed button

Using the airflow speed button, you can set the airflow speed in 4 steps in the following order: Step 1 → Step 2 → Step 3 → Turbo. (If you press the airflow speed button during an operating mode, it switches to manual mode immediately.)

3 Humidity button

Using the Humidity button, you can set the humidity level in the following order: 40% → 50% → 60% → Continuous operation. (The configured humidity is only applied in Auto mode.)

4 Off-timer button

Pressing the Off-timer button changes the indicator in the following order: "1hr → 4hr → 8hr". If the off-timer is cancelled, all the indicator lamps are turned off.

5 Air quality indicator



Represents the pollution level by the color of the indicator.

- Clean: Blue
- Low pollution level: Bright violet
- Medium pollution level: Dark violet
- High pollution level: Red

AIR PURIFICATION PROCESS

Air purification system

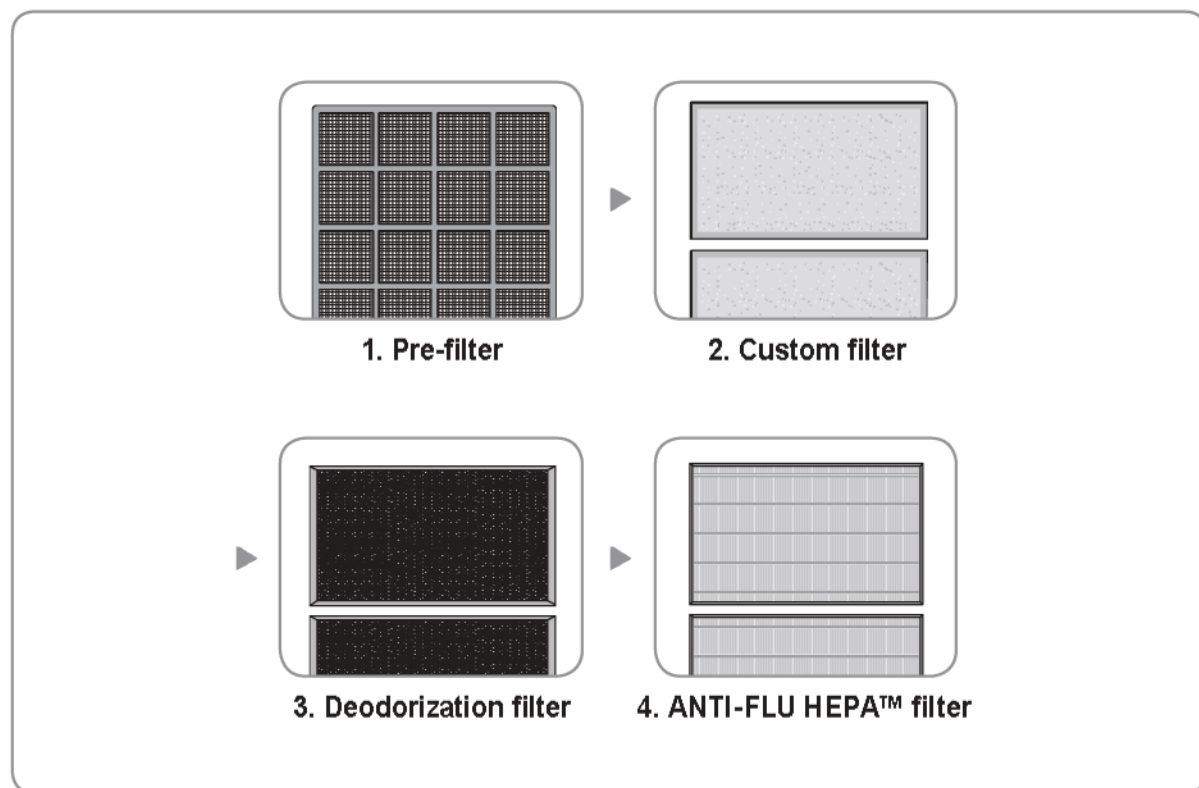

Pre-filter

It removes relatively large dust and mold, human hair, pet hair, and so on.

Custom filter

Customers can select one of 3 types of custom filters according to their requirements: dust, new-house or old-house filters.

Deodorization filter

The activated carbon particles of the Deodorization filter effectively eliminate food odors and unpleasant household smells.

ANTI-FLU HEPA™ filter

Coway's innovative ANTI-FLU HEPA™ captures micro particles and inactivates viruses up to 99.9 %. Natural substances from Ginkgo and Japanese sumac trees destroy the protein on the surface of viruses.

It also effectively removes fine dust and cigarette smoke while the antibacterial and anti-mold functions of the organic antibacterial materials eliminate germs and mold.

AIR HUMIDIFICATION PROCESS

Humidifying air purification process

- ❶ Water tank
 - Contains 3 L of water, provides an anti-bacterial effect and promotes the ion-exchange of water.
- ❷ Water tray
 - Supplies the appropriate amount of water from the water tank to the humidification filter and provides an anti-bacterial effect.
- ❸ Humidification filter
 - The humidification filter absorbs water. As the purified air from the air outlet passes through the humidification filter, naturally humidified air is generated.

PREPARATIONS

How to Install Filter



Tips

- Make sure to remove each filter's plastic packaging before installing the filters.
- This product is for home use only. Use the product indoors only.
- When the unit is not in use, disconnect the power plug from the electric outlet.
- Check the front part of the filter when installing it.

* The filter order: Pre-filter → Custom filter → Deodorization filter → ANTI-FLU HEPA™ filter

❶ Open the front cover.

Open the front cover by pulling it at the bottom.

- Take care when you do this because excessively pulling the top or middle part of the front cover may damage the product.

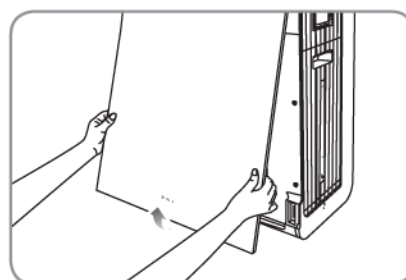

❷ Take the filter out and remove the plastic packaging.

Remove the plastic packaging from the filters except for the pre-filter and then install the filters according to the order of the filters.

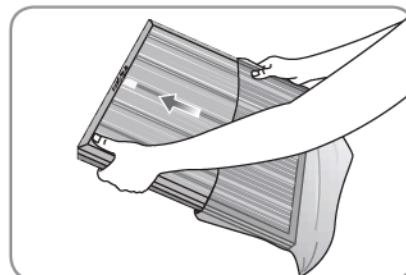
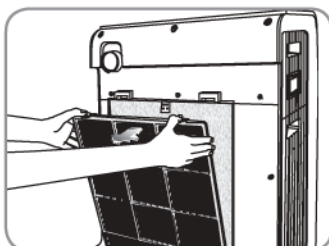



Humidification filter

- 1 Separate the water tank.

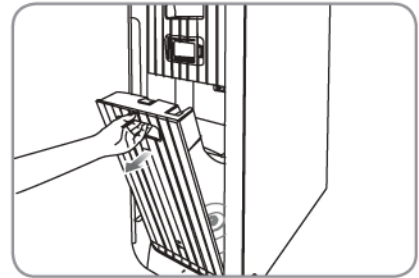

- 2 Separate the water tray as shown by the figure.

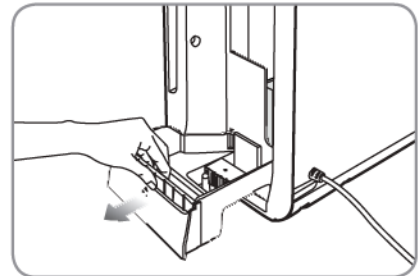

- 3 Install the humidification filter for which the plastic packaging has been removed.
 - Install the filter so that the thin filter faces the front and the thick filter faces the back.
 - Although the humidification filter has a front and a back, it does not have a top and a bottom.

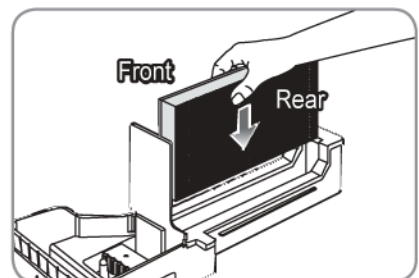

- 4 Install the water tray and the water tank in this order.

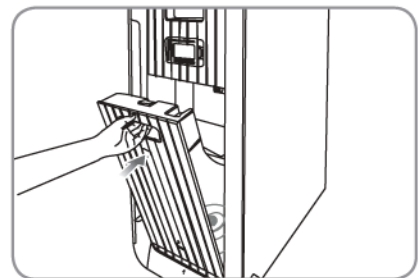
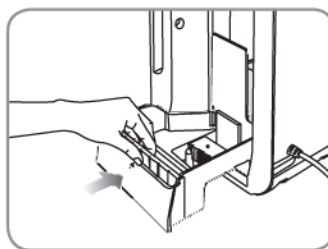

- The amount of moisture supplied by the humidification filter may decrease as it is contaminated by scale. Clean the filter at least once a week (see p.15).
- If you do not want to use the humidification function, remove the humidification filter, dry it completely in the shade and store it in a separate location.
- If the water tank or the water tray is not properly installed, the product will not work.



HOW TO USE



Tips

- Connect the power plug to the electrical outlet before operating the product.
- When the air purifier is turned on, it automatically operates in Auto mode.



To Operate the Manual Mode

Turn the product on by pressing the Power button and select an airflow speed by pressing the Airflow speed button.

Step 1 → Step 2 → Step 3 → Turbo

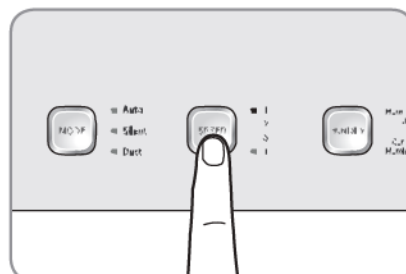

To Select the Auto Mode

Turn the product on by pressing the Power button and select a mode by pressing the Mode button.

Auto → Silent → Dust

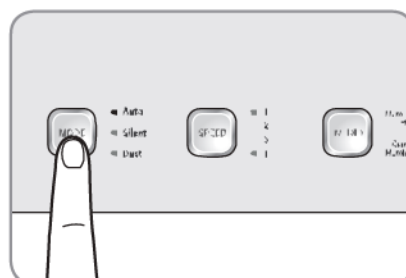

► Auto mode

Automatically controls the airflow speed (Step 1, 2, 3 and 4) according to the air pollution level detected by the particle sensor in order to purify the air more effectively. This operating mode is appropriate for general users.

	Pollution level 1	Pollution level 2	Pollution level 3 or higher
Airflow speed	Step 1	Step 2	Step 3

► Silent mode

Minimizes the airflow for the air purification or humidifying air purification operation to ensure a quiet, pleasant environment. This mode is a low-noise and low power consumption mode.

- In Silent mode, the Airflow speed indicator is turned off.

► Dust mode

This mode effectively removes any house dust in the room.

This mode maximizes the airflow to remove the house dust from the air in the room.

The airflow speed continually alternates between steps 3 and 1 regardless of the pollution level. Airflow speed step 3 continues for 10 minutes and then step 1 continues for 30 minutes. Airflow speed step 3 blows the house dust into the air and step 1 purifies the air.

► Sleep mode (only when Auto mode is selected)

If the surrounding illumination is dark for more than 3 minutes, the unit automatically switches to sleep mode, lowers the airflow speed, noise and power consumption.

If the surrounding illumination is bright again for 5 minutes or longer, the unit resumes normal operations.

In sleep mode, all displays except for the power indicator are turned off.



Off timer ON/OFF

Using the off timer function, you can select 1, 4 or 8 hours before the unit is turned off.

- To cancel an off timer, press the off-timer button until the off-timer indicator is turned off.
(1hr → 4hr → 8hr → cancel)

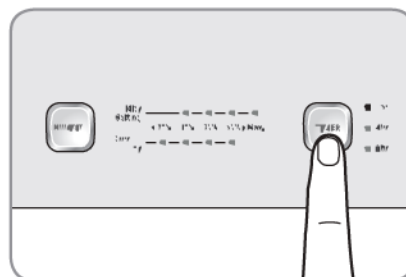

To use the humidifying air purification function

- 1 To use the humidifying air purification function, fill the water tank with water.

- If you fill the water tank with water, it is automatically detected by water level sensor and the humidifying air purification function starts. If the sensor detects that the water tank is empty, the humidification indicator is turned off and the unit automatically switches to the air purification operation.

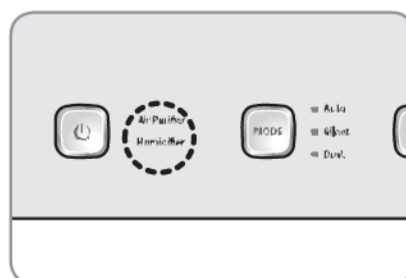

- 2 Set a humidity level by pressing the humidity button.

- You can select Auto mode and adjust the airflow speed even during the humidifying air purification operation.
- The configured humidity is only applied in Auto mode.

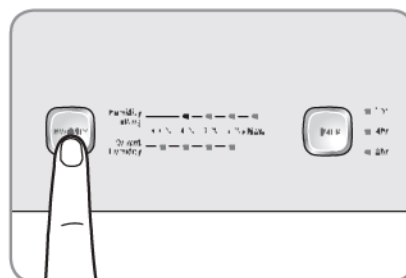

Precautions for installing the water tank

Insert the water tank into the product until it clicks into place.

If the water tank is not completely installed, it may result in a water leakage or malfunction of the product.

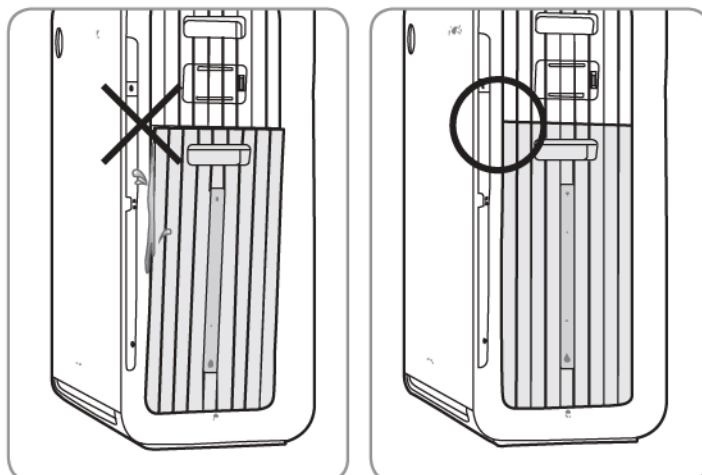

ADJUST PARTICLE SENSOR



When the product is shipped, the pollution sensor is set to normal sensitivity. If the pollution level stays at the highest level after 2 hours of operating or stays at the lowest level for more than 1 hour when the air does not appear clean, users can adjust the sensitivity of the sensor.

- 1 While the air purifier is in operation, press and hold the Airflow speed and Mode buttons at the same time for 3 seconds or more.

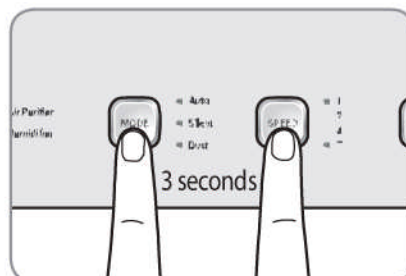

- 2 The Airflow speed indicator blinks at an interval of approximately 0.5 seconds.

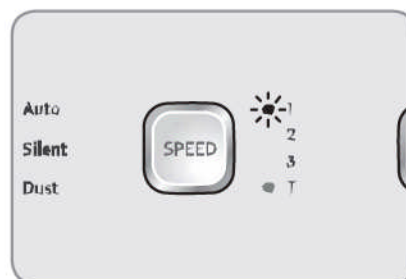

- 3 Adjust the sensor sensitivity by pressing the Airflow speed button. The sensitivity of the sensor is represented by the blinking airflow speed indicator.

Step 1	Step 2	Step 3
Sensitive	Normal	Insensitive

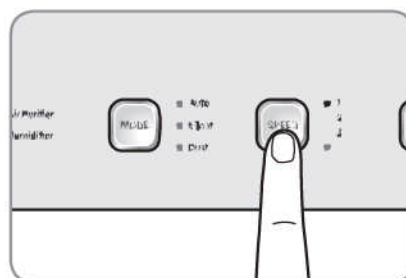

- 4 When the Airflow speed and Mode buttons are pressed and held simultaneously for 2 seconds or more, the system returns to normal operation, saving the sensitivity setting.
 - If no button is pressed for 10 seconds, the current sensitivity is automatically saved.

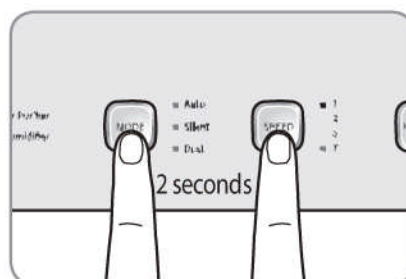



FILLING UP THE WATER TANK



To fill the water tank with water

- 1 Separate the water tank from the side of the product by pulling the separation catch.



- 2 Separate the water tank cap by turning it counterclockwise.

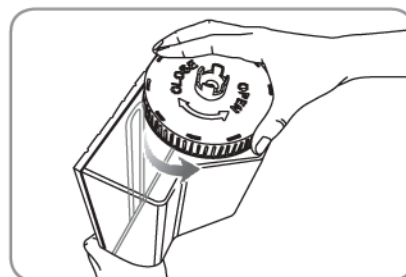

- 3 Fill the water tank with water and turn the water tank cap clockwise until you hear a popping sound.

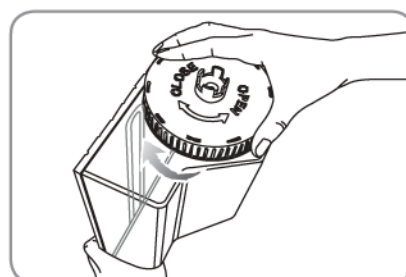

Do not touch the anti-scale filter of the water tank cap as this may result in a problem with the product performance.



CLEANING METHOD



Tips

- Always unplug the unit before cleaning it.
- Do not use detergents that contain organic solvents (solvent, thinner, etc), bleach, chlorine, or abrasives.
- Do not place the unit into water or spray water onto it.



Cleaning Air Inlet and Outlet (every 2 months)

Clean the air inlet and outlet with a soft brush.

- Take care that no dust enters the air purifier when cleaning it.

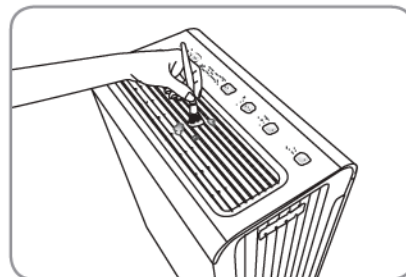

Cleaning Particle Sensor (every 2 months)

- 1 Open the particle sensor cover on the right-hand side of the product. First, clean the air inlet and outlet vents and then the particle sensor using a soft brush or vacuum cleaner.

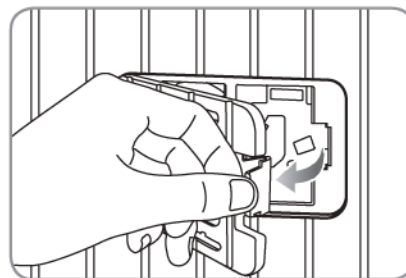

- 2 Use a slightly damp cotton swab and lightly clean the lens, dust inlet and outlet. Then use a dry cotton swab to remove any remaining moisture.

- Without regular cleaning, the performance of the particle sensor will deteriorate.
- The cleaning cycle differs depending on the operating environment. When using the product in a dusty environment, you will need to clean the sensor more often.

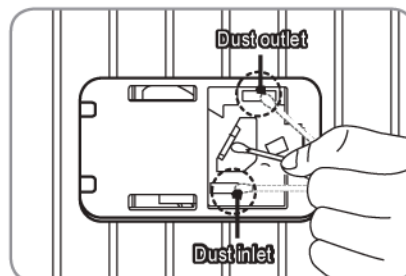

Cleaning front cover

Separate the front cover from the unit and remove any dust attached to the surface with a soft cloth or brush. Use a damp cloth if the contamination is serious. (However, do not use abrasives.)

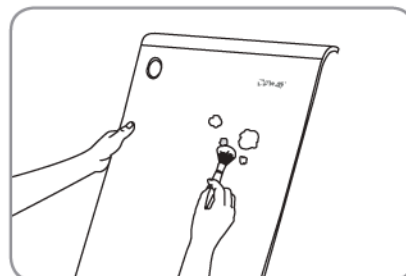

Cleaning the Unit (every 2~4 weeks)

Use a dry, soft cloth to clean the product body. Use a damp cloth if the contamination is serious. (However, do not use abrasives.)

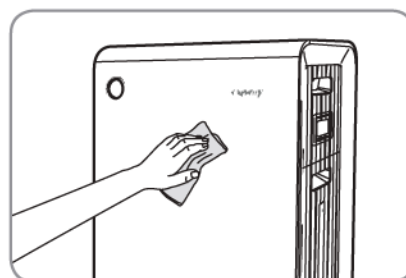



Cleaning the water tank (daily)

- 1 Separate the water tank from the side of the product and open the water tank cap at the bottom of the water tank by turning it counterclockwise. If there is any residual water in the water tank, empty the water tank before cleaning it.

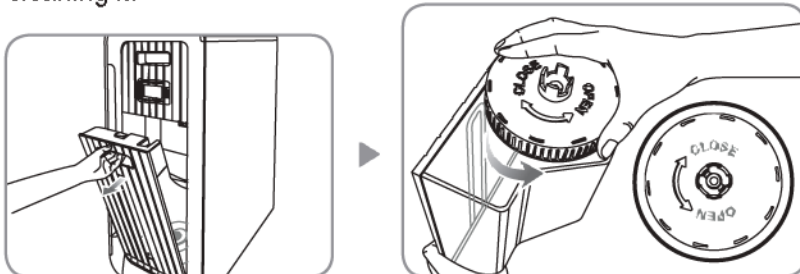

- 2 Separate the anti-scale filter from the water tank cap. Add water and a small amount of neutral detergent into the water tank until approximately 1/3 of the water tank is filled and close the cap by turning it clockwise. Shake the water tank holding it with both hands as shown by the figure, so that all sides of the water tank can be washed.

- Since the water tank is large, you can clean it by putting your hand into the water tank.
- Do not add a neutral detergent into the water tank when the anti-scale filter is installed. This will degrade the product performance.

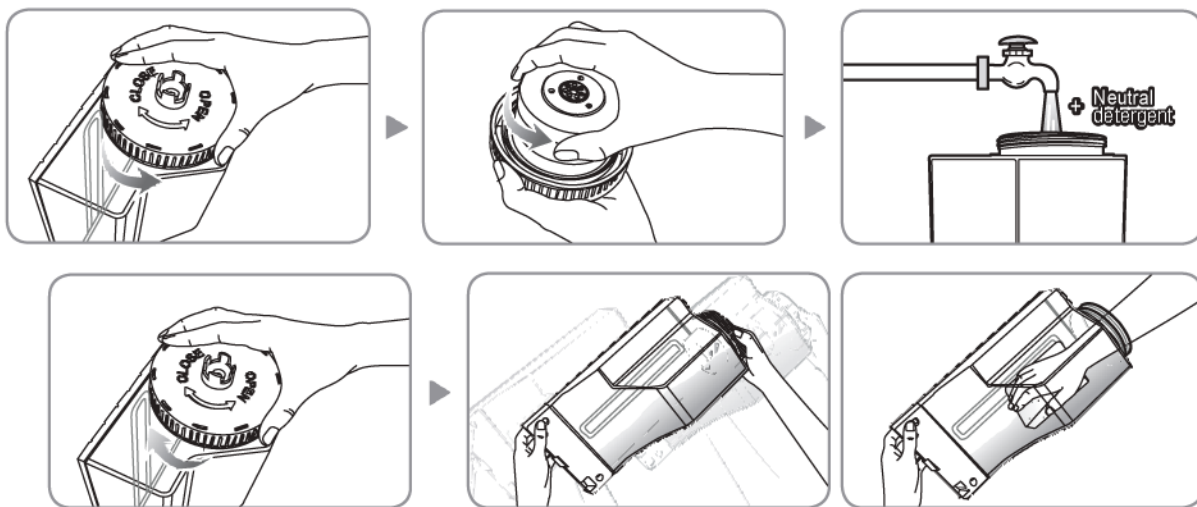

- 3 Open the water tank cap by turning it counterclockwise and clean it under flowing water.

Wash the anti-scale filter under flowing water and install it into the water tank cap.

- Avoid external impacts to the water tank. A strong impact may damage the water tank. This may result in water leakage.
- When closing the cap, fasten it firmly in the direction of CLOSE (clockwise) until you hear a popping sound.
- If the cap is not completely fastened, it may result in a water leakage.





CLEANING METHOD



Cleaning the water tank (daily)

④ Dry the water tank completely in a shady location to remove all moisture before installing it.

- To operate in humidifying air purification mode: Remove any moisture from outside the water tank, fill up the water tank with water and install the water tank.

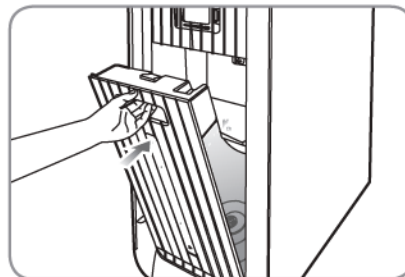

- To operate in air purification mode: Remove any moisture from outside and inside the water tank and install the water tank.



Cleaning the water tray (daily)

① Separate the water tank from the product and separate the water tray from the side of the product by pulling it.

- When you remove the water tray as shown by the figure, take care because there may be residual water in the hole of the catch.

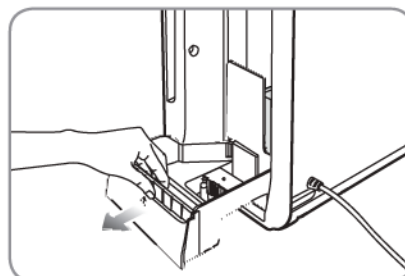
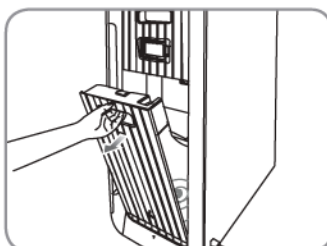

② Carefully separate the humidification filter from the water tray.

- When you separate the humidification filter, some water absorbed by the filter can be extracted. Please take care of the water.
Soak the humidification filter in warm water (40 °C or lower) for at least 20 minutes and softly wash it with a cleaning brush under flowing water.
- The period and intensity of the scale accumulation at the front of the humidification filter may differ depending on the TDS of the water. If the filter is whitened by the accumulated scale, wash it under flowing water.





- 3 Separate the humidification filter, the blocking film and the water tray cover from the water tray in this sequence, and then wash the water tray with a damp, soft cloth or cleaning brush using a neutral detergent under flowing water. Wipe away the moisture from the water tray with a soft, dry cloth and dry it in the shade.

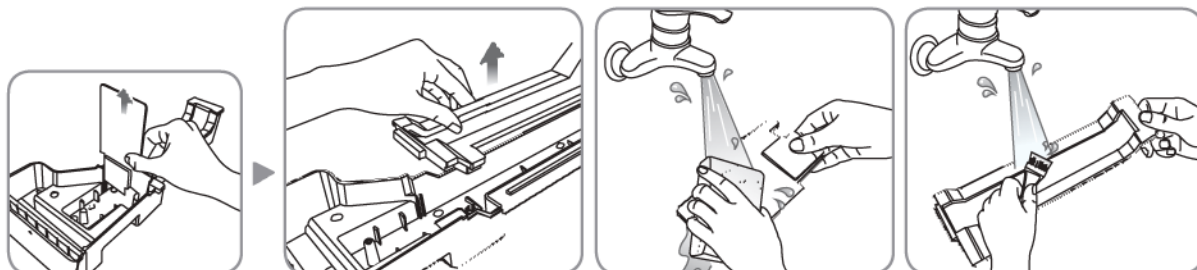

- 4 Remove the anti-bacterial case from the water tray and clean it with a cleaning brush.

- Insert the anti-bacterial case into the water tray so that the arrow indicates the inside of the humidification filter.

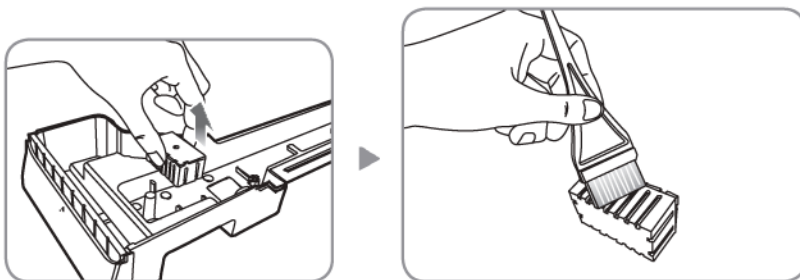

- Assemble the water tray cover and assemble the blocking film aligning it to the rail.

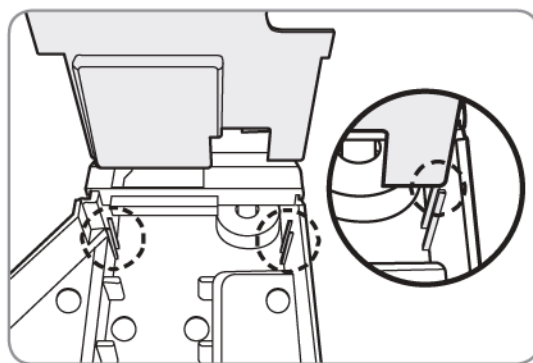

CLEANING METHOD



Tips

- Always unplug the unit before cleaning the filters.
- The Pre-filter is reusable by removing dust or cleaning it with water.
- If the Pre-filter is not cleaned for a long time, the product performance may deteriorate.
- The Custom, Deodorization, and ANTI-FLU™ filters cannot be reused even when cleaned.
- Do not clean them with water.



Cleaning Pre-filter (every 2 - 4 weeks)

- ❶ Open the front cover by pulling the bottom part of the cover where the air inlet is located.

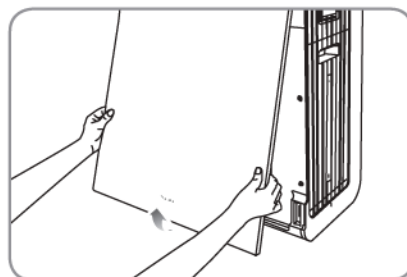

- ❷ Remove the pre-filter by pushing the filter catches.

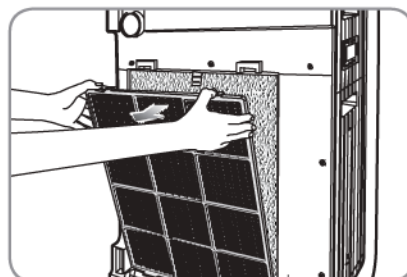

- ❸ Clean the filter with a vacuum cleaner or with water depending on the level of contamination.

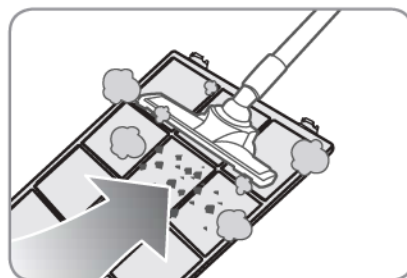

- ❹ Install the pre-filter after completely removing any moisture. Fit the front cover back onto the product.

- When installing the pre-filter, make sure that you hook the catches properly.

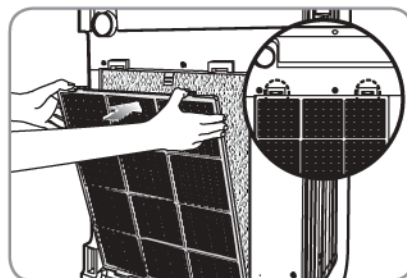



FILTER REPLACEMENT



- Check that the 'front' of each filter is facing in the correct direction.
- To maintain the optimal performance of the product, use the original Coway filters.
- Always unplug the unit before replacing the filters.



Replacing the air purification filter

When replacing the HEPA filter, check that the front is facing the correct direction.

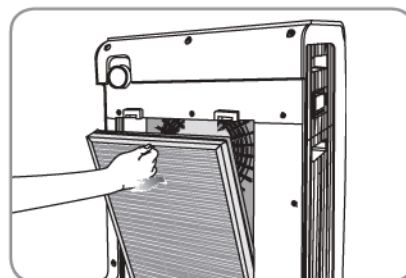

Replacing the humidification filter

- 1 Separate the water tank from the product and separate the water tray from the side of the product by pulling it.

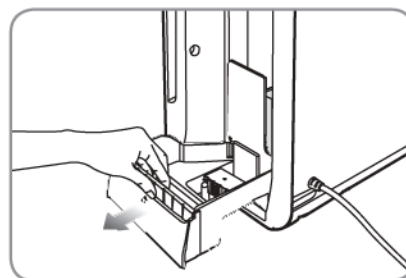

- 2 Hold the humidification filter carefully so that no water spills and then replace it.

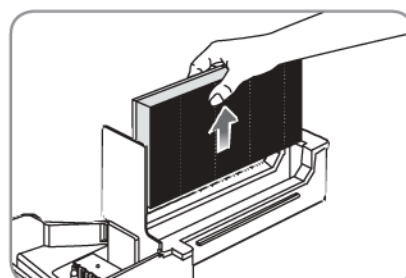



FILTER REPLACEMENT



Replacing the anti-scale filter

- 1 Separate the water tank from the product and open the water tank cap at the bottom of the tank by turning it counterclockwise.



- 2 Remove the anti-scale filter case from the water tank cap by turning it counterclockwise and then replace it.



Replacing the anti-bacterial filter

- 1 Separate the water tank from the product and separate the water tray from the side of the product by pulling it.

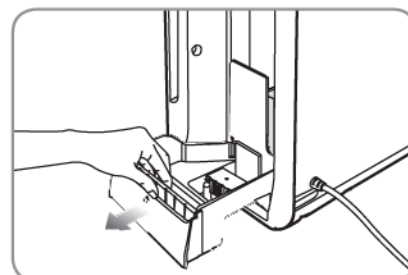

- 2 Remove the anti-bacterial filter by pulling it upward and replace it.
 - Insert the anti-bacterial case into the water tray so that the arrow indicates the inside of the humidification filter.

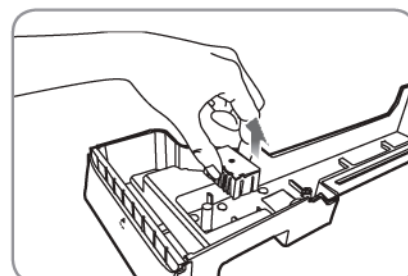

Filter cleaning and replacement cycle

Filter		For Home Use	Cleaning / Replacement
Pre-filter		Every 2 ~ 4 weeks	Cleaning and washing
Custom filter		Every 6 months	Replacement
Deodorization filter		Every 12 months	Replacement
ANTI-FLU HEPA™ filter		Every 12 months	Replacement
Humidification filter	Front	Every 6 months	Replacement
	Back	Every 6 months	Replacement
Anti-scale filter		Every 6 months	Replacement
Anti-bacterial filter		Every 6 months	Replacement



Each service life is based on 24-hour use in Auto mode.



The filter replacement cycle is a recommendation and may differ depending on the operating environment.



NATURAL VAPORIZATION HUMIDIFICATION



Operating mechanism

The humidification method adopted by this product is a natural vaporization humidification type. The humidification part consists of three parts, the water tank, the water tray and the humidification filter. The water tank supplies water to the water tray and the humidification filter installed in the water tray absorbs water. The dry air that is inhaled into the product is changed to humidified air as it passes through the holes of the humidification filter and the humid air humidifies the air in the room.

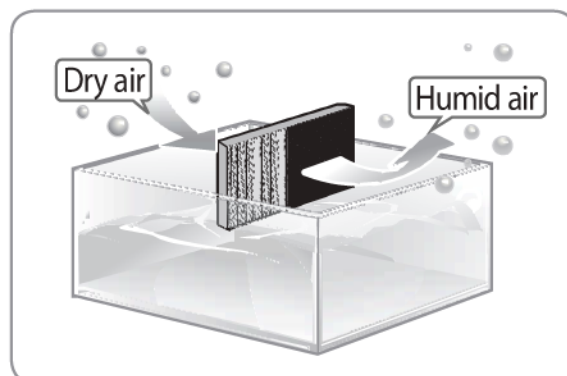

- As the warm, dry air passes the humidification filter, it acquires moisture and loses heat, and the airflow from the product is colder than it was, you may feel that the air is cooler depending on the size or temperature of the room.
- The amount of moisture supplied by a natural vaporization humidification type varies depending on the surrounding temperature or humidity. Therefore, if the humidity is high or the temperature is low, the amount of moisture supplied by the humidification function may be low.



Advantages

In the case of an ultrasonic type humidifier, since the water particles that are sprayed into the air are big and heavy, only the area around the humidifier is humidified and the area around the humidifier becomes wet after operating for a long time. However, since the natural vaporization humidification vaporizes water in the same way that water is vaporized naturally and the water particles are small and light, not only are respiratory organs not irritated and the surrounding area does not become wet, but also the entire area is humidified evenly.



Coverage of the ideal temperature/humidity

This product is designed for a 33 square meter area. If this product is used in a large space, the humidification effect may not be satisfactory. (To humidify a large area, set the airflow speed to step 3 or higher in humidifying air purification mode.)



TROUBLESHOOTING

The air purifier may operate abnormally because of a minor issue or because the user is unfamiliar with the product and not because of a product malfunction. In such a case, problems can be solved easily without help from the Service Center by checking the following. If the problem remains unsolved, please call our Service Center.

Symptom	Check-list	Measures to take
No air is blowing.	• Is the power cord connected?	Connect the power cord to an electric outlet for 220 V - 240 V ~ 50Hz / 60 Hz.
	• Is the display completely turned off?	Press the power button and then select a function.
	• Has the power gone off?	Use the air purifier after the power has turned on again.
	• Is the water tank not installed properly?	Install the water tank properly.
The airflow speed does not change.	• Is the operating mode Manual?	Set the correct operating mode.
	• Is the operating mode set to Silent mode?	In Silent mode, the airflow speed is fixed to the minimum level.
The airflow is significantly low.	• Have the filter cleaning and replacement times passed?	Check the filter cleaning and replacement cycle and then clean or replace the filter(s) if necessary.
The pollution level does not change.	• Is the pollution sensor contaminated by dust?	Clean the pollution sensor.
	• Does the pollution level keep indicating a high level?	Set the pollution sensor sensitivity to Insensitive or Normal.
	• Does the pollution level keep indicating a low level?	Set the pollution sensor sensitivity to Sensitive or Normal.
A bad smell is coming from the air outlet.	• Have the filter cleaning and replacement times passed?	Check the filter cleaning and replacement cycle and then clean or replace the filter(s) if necessary.
The air quality indicator blinks.	• Request service or contact our Service Center.	
When other functional problems are detected.	• Check the symptoms, unplug the product, and then request service or contact our Service Center.	
All the humidity indicators blink.	• Request a service or contact our service center.	
The humidification indicator blinks.	• Is the water tank installed properly?	Install the water tank properly.